

**Lokalna studija lokacije "Pijaca" -**  
katastarska parcela 2315/4 u Tuzima



R = 1 : 1000

**9a**

**plan**  
**SAOBRAĆAJ - podzemna garaza**

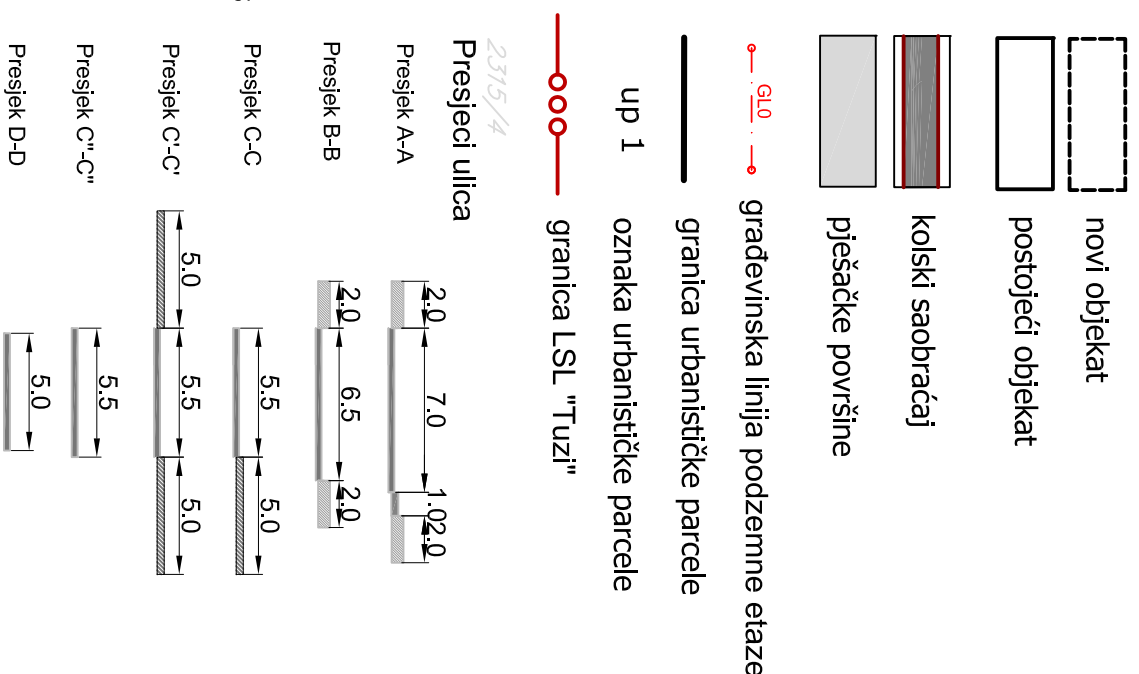

- koordinate Urbanističke parcele 4
- X=6609712.379 Y=4691770.130
  - X=6609810.402 Y=4691815.054
  - X=6609831.179 Y=4691740.877
  - X=6609722.580 Y=4691707.640

- koordinate osovina saobraćajnice
- G1. X=6609763.149 Y=4691788.997
  - G2. X=6609765.413 Y=4691782.882
  - G3. X=6609750.670 Y=4691776.127
  - G4. X=6609729.691 Y=4691766.510
  - G5. X=6609736.881 Y=4691772.505
  - G6. X=6609763.534 Y=4691730.664
  - G7. X=6609774.429 Y=4691733.986
  - G8. X=6609776.338 Y=4691727.758
  - G9. X=6609778.730 Y=4691735.317
  - G10. X=6609794.034 Y=4691794.002
  - G11. X=6609805.034 Y=4691743.370
  - G12. X=6609825.603 Y=4691749.667
  - G13. X=6609810.518 Y=4691803.546
  - G14. X=6609790.724 Y=4691794.478
  - G15. X=6609780.140 Y=4691789.628

Broj parking mjesta  
 Parking mjesta za putnička vozila = 115  
 Parking mjesta za teretna vozila = 10  
 SUMA 125

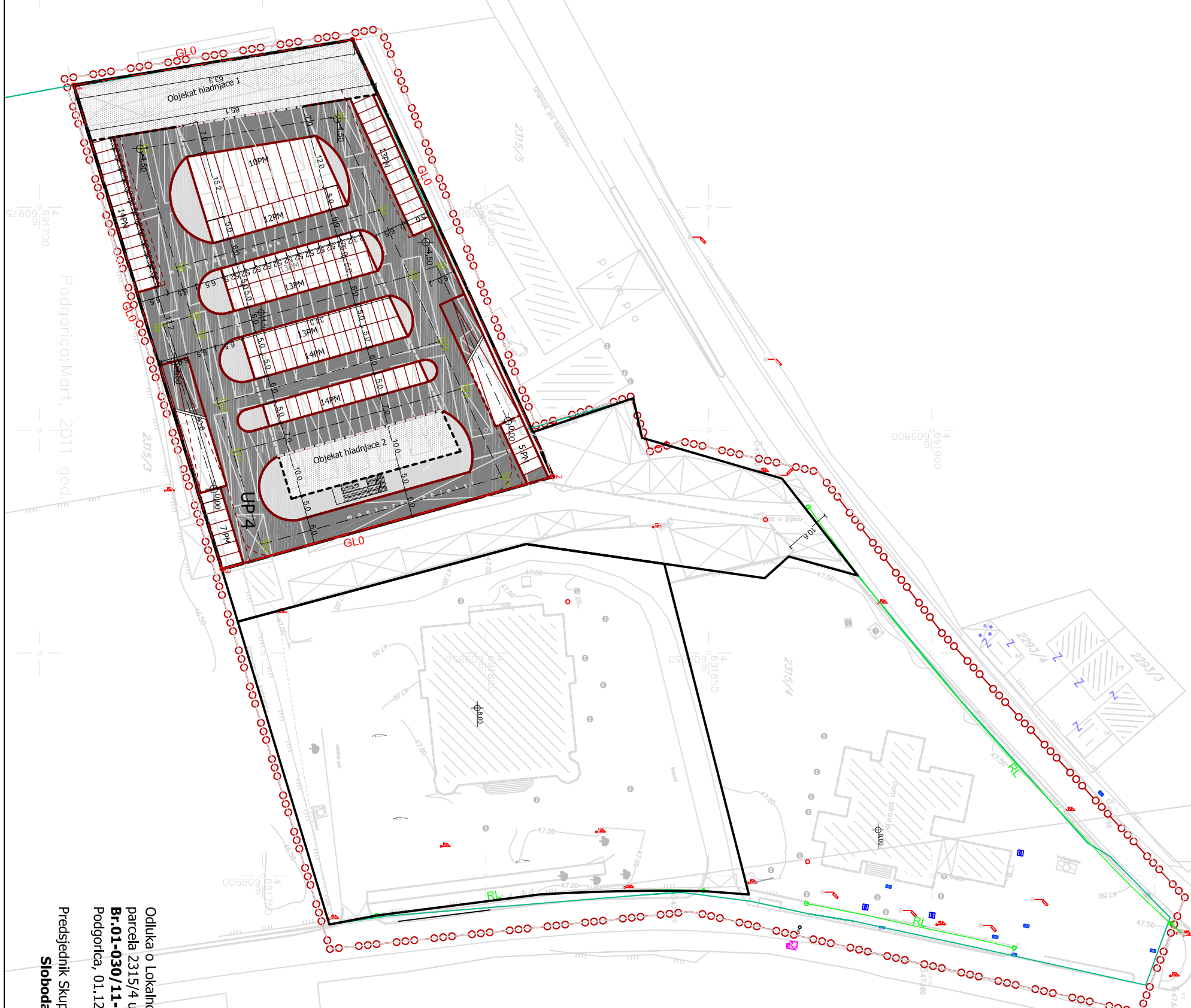

Odluka o Lokalnoj studiji lokacije "Pijaca" -kat.  
 parcela 2315/4 u Tuzima  
**Br.01-030/11-1322**  
 Podgorica, 01.12.2011 godine

Predsjednik Skupštine Glavnog grada  
**Slobodan Stojanović**

Naručilac  
**Opština Podgorica**  
 Agencija za izgradnju i razvoj Podgorice

Obradivatelj  
**INKOPLAN** d. o. o - Podgorica  
 Septembar 2011. godina

Podgorica: Mart, 2011 god.  
 2315/2  
 2315/5  
 2315/4  
 2315/3